

**FISHER & PAYKEL**

**WALL RANGE HOOD, CHIMNEY PYRAMID**

---

**CLASSIC**

HC24PCX1, HC30PCX1, HC30PCB1, HC30PCR1, HC30PCW1, HC36PCX1,  
HC36PCB1, HC36PCR1 & HC36PCW1

**USER GUIDE**

**US CA**



# CONTENTS

EN

---

Safety and warnings	5
Control panel	8
Care and cleaning	9
Parts and accessories	11
Warranty and service	12

---

## Registration

To register your product visit our website: [fisherpaykel.com/register](https://fisherpaykel.com/register)



**⚠ WARNING!****Electric Shock Hazard**

Failure to follow this advice may result in electric shock or death.

- Always disconnect the appliance from the mains power supply before carrying out any maintenance or repairs. Failure to do so can result in death, electric shock, fire or injury to persons.
- Do not immerse cord or plugs in water or other liquid.

**⚠ WARNING!****Weight Hazard**

Failure to follow this advice may result in personal injury

- The appliance is heavy. Please ensure adequate care is taken when installing the appliance to prevent personal injury. The appliance must be installed onto a solid wall, stud, beam or truss.
- **Product weight:** HC24 42 lb (19 kg), HC30 35 lb (21.5 kg), HC36 37 lb (23.8 kg).

**READ AND SAVE THESE INSTRUCTIONS****WARNING!**

When using this appliance always exercise basic safety precautions including the following:

**General**

- **CAUTION:** For general ventilating use only. Do not use to exhaust hazardous or explosive materials and vapors.
- This appliance is not intended for use by persons (including children) with reduced physical, sensory or mental capabilities, or lack of experience and knowledge, unless they have been given supervision or instruction concerning the use of the appliance by a person responsible for their safety.
- Children should be supervised to ensure they do not play with the appliance. Cleaning and user maintenance shall not be made by children without supervision.
- Never use the range hood without the filters in place.
- **CAUTION:** accessible parts may become hot when used with cooking appliances.
- Remove all packaging, including protective wrappings, before use.
- The range hood may stop working during an electrostatic discharge (eg lightning). Switch off the electricity supply to the range hood and reconnect after one minute.

**Cleaning**

- There is a fire risk if cleaning is not carried out in accordance with the instructions.
- Unplug or disconnect the appliance from the power supply before servicing or cleaning.
- Never use abrasive or oil based cleaners.
- Wear gloves to protect against sharp edges.

## SAFETY AND WARNINGS

---

- When replacing the bulb, let the bulb cool, and ensure that power to the range hood has been turned off.
- Use new bulbs according to that indicated on the range hood nameplate.

### Fire

**WARNING!** To reduce the risk of fire, electric shock, or injury to persons, observe the following:

- Use this unit only in the manner intended by the manufacturer. If you have questions, contact the manufacturer. For residential use only.
- Before servicing or cleaning unit, switch power off at service panel and lock the service disconnecting means to prevent power from being switched on accidentally. When the service disconnecting means cannot be locked, securely fasten a prominent warning device, such as a tag, to the service panel.
- Installation work and electrical wiring must be done by qualified person(s) in accordance with all applicable codes and standards, including fire-rated construction.
- Sufficient air is needed for proper combustion and exhausting of gases through the flue (chimney) of fuel burning equipment to prevent back drafting. Follow the heating equipment manufacturer's guideline and safety standards such as those published by the National Fire Protection Association (NFPA), and the American Society for Heating, Refrigeration and Air Conditioning Engineers (ASHRAE), and the local code authorities.
- When cutting or drilling into wall or ceiling, do not damage electrical wiring and other hidden utilities.
- Ducted fans must always be vented to the outdoors.
- This unit must be grounded.
- Never leave frying food unattended since grease can overheat and catch fire. The risk of fire is even greater in the case of used oil.

**WARNING:** To reduce the risk of injury to persons in the event of a range top grease fire, observe the following\*:

- **SMOTHER FLAMES** with a close-fitting lid, cookie sheet, or metal tray, then turn off the burner. **BE CAREFUL TO PREVENT BURNS.** If the flames do not go out immediately, **EVACUATE AND CALL THE FIRE DEPARTMENT.**
- **NEVER PICK UP A FLAMING PAN** - You may be burned.
- **DO NOT USE WATER**, including wet dishcloths or towels - a violent steam explosion will result.
- Use an extinguisher **ONLY** if:
  - You know you have a Class ABC extinguisher, and you already know how to operate it.
  - The fire is small and contained in the area where it started.
  - The fire department is being called.
  - You can fight the fire with your back to an exit.

\* Based on "Kitchen Firesafety Tips" published by NFPA.

**WARNING: To reduce the risk of a range top grease fire:**

- Never leave surface units unattended at high settings. Boilovers cause smoking and greasy spillovers that may ignite. Heat oils slowly on low or medium settings.
- Always turn hood ON when cooking at high heat or when flambéing food (ie Crepes Suzette, Cherries Jubilee, Peppercorn Beef Flambé)
- Clean ventilating fans frequently. Grease should not be allowed to accumulate on fan or filter.
- Use proper pan size. Always use cookware appropriate for the size of the surface element.

# CONTROL PANEL

---

## Control panel



①

②

③

④

---

## CONTROL PANEL FEATURES

---

- ① Light
- ② Fan speed 1
- ③ Fan speed 2
- ④ Fan speed 3



This range hood should be cleaned regularly using a mild, liquid detergent and a clean soft cloth to avoid a build-up of grease occurring. Avoid the use of corrosive chemicals, abrasive cleaning products, hard brushes and steel wool pads. Grease deposits are corrosive which can cause damage.

In areas of high humidity or coastal environments, cleaning should be carried out more frequently. Disconnect the product from the power source before undergoing any cleaning.

Do not operate the hood without filters in place.

## Aluminum filters

- Clean the filters at least once a month. Filters may need to be cleaned more frequently depending on the cooking methods used and frequency of use.
- Aluminum filters should be removed and cleaned with hot soapy water or in a dishwasher.
- If washed in a dishwasher, the filter should be placed in an upright position to prevent food from falling on them.
- After rinsing and drying, refit the filters.

## Removing the aluminium filters

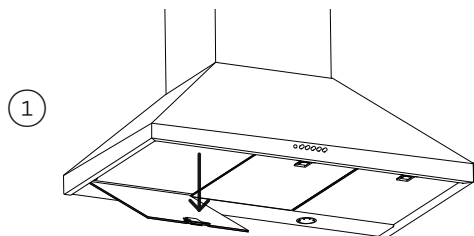

Pull the catch and tilt the filter downwards until it disengages from the supports.

## Replacing the aluminium filters

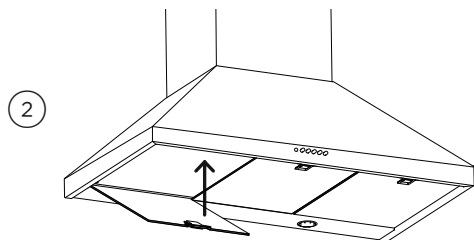

Place the filter into the support at the rear of the range hood. Push the filter back into place.

## CARE AND CLEANING

---

### Replacing the light bulb

①

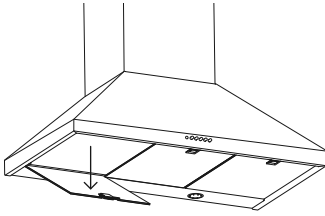

Remove the aluminum filters.

②

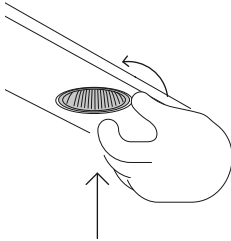

Lightly push the light bulb up and rotate anti-clockwise to remove.

③

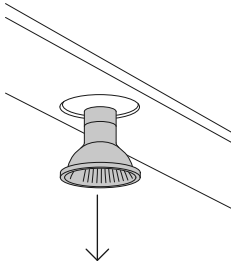

Replace light bulb with a light bulb no more powerful.  
Refer to range hood rating plate for detail.

④

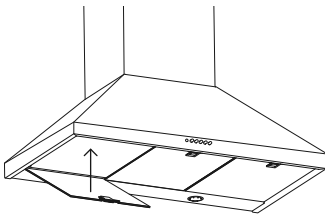

Refit the aluminum filters.

## PARTS AND ACCESSORIES

EN

ITEM	REFERENCE NUMBER
LED bulb	792579
Recirculation diverter	792580

## WARRANTY AND SERVICE

---

### Before you call for service or assistance

Check the things you can do yourself. Refer to the installation guide and user guide and check that:

- Your product is correctly installed.
- You are familiar with its normal operation.

If after checking these points you still need assistance or parts, please refer to the Service & Warranty book for warranty details and your nearest Service Center, Customer Care, or contact us through our website [www.fisherpaykel.com](http://www.fisherpaykel.com)

---

### Complete and keep for safe reference:

Model \_\_\_\_\_

Serial No. \_\_\_\_\_

Purchase Date \_\_\_\_\_

Purchaser \_\_\_\_\_

Dealer \_\_\_\_\_

City \_\_\_\_\_

State \_\_\_\_\_

Zip \_\_\_\_\_

Country \_\_\_\_\_

**FISHERPAYKEL.COM**

© Fisher & Paykel Appliances 2020. All rights reserved.

The models shown in this guide may not be available in all markets  
and are subject to change at any time.

The product specifications in this guide apply to the specific products and  
models described at the date of issue. Under our policy of continuous product  
improvement, these specifications may change at any time.

For current details about model and specification availability in your country,  
please go to our website or contact your local Fisher & Paykel dealer.

**105937C 06.20**