

FISHER & PAYKEL

**FRONT LOADER
WASHING MACHINE**

WH1060S1

USER GUIDE

UK IE EU

CONTENTS

Safety and warnings	5
Safety features	7
Control panel	9
Wi-Fi connection & remote mode	12
Wash cycles	14
Detergent and softener	16
Wash preparation	19
Getting started quickly	21
Customising a wash cycle	23
Factory reset	29
Caring for your washer	30
Before you call for service	35
Fault codes	37
Troubleshooting	38
Energy consumption & cycle times	43
Manufacturer's warranty	44
Customer care	44

Registration

To register your product visit our website: fisherpaykel.com/register

⚠ WARNING!



Electric Shock Hazard

Failure to follow this advice may result in electric shock or death.

- If you are using an extension cord or a portable electrical outlet device (eg multi-socket outlet box), ensure that it is positioned so that it does not come into contact with water or moisture.

READ AND SAVE THIS GUIDE

When using your clothes washer, follow basic precautions, including the following:

General

- This product has been designed for personal, family or household use. This product is not designed for any commercial use. Any commercial use will terminate this products manufacturer's warranty.
- A damaged power cord must be replaced by a Fisher & Paykel trained and supported service technician or similarly qualified person in order to avoid a hazard. Do not use the appliance until it has been repaired to avoid a risk of electric shock.
- Do not operate this machine if it has been damaged during transport. Contact your Fisher & Paykel dealer or Fisher & Paykel trained and supported service technician.
- This appliance can be used by children aged 8 years and above and persons with reduced physical, sensory or mental capabilities or lack of experience and knowledge if they have been given supervision or instruction concerning use of the appliance in a safe way and understand the hazards involved.
- Keep children away from the washer while it is in operation.
- Supervise children to ensure they do not play with the washer or climb inside the drum.
- Children of less than 3 years should be kept away unless continuously supervised
- The washer should only be used for washing and rinsing of textiles where this is indicated on the care label.
- Do not add petrol, dry-cleaning solvents, or other flammable or explosive substances to the wash water. These substances give off vapours that could ignite or explode.
- Do not wash articles that have been previously cleaned in, washed in, soaked in, or spotted with gasoline, dry-cleaning solvents, or other flammable or explosive substances as they give off vapours that could ignite or explode.
- The door will be locked from the start of the cycle until the cycle is complete for safety reasons. It is possible to open the door during the cycle under certain conditions. Never force the door open.
- Do not touch the door during a cycle as the door can become hot.
- When 90°C temperature is selected, the door glass will become hot. Do not touch the glass part of the door. Keep children away from the washer.
- Do not touch or operate the machine with wet hands or with bare-feet.
- Do not open the detergent dispenser during the cycle as hot water may come out of it.
- Cleaning and user maintenance shall not be made by children without supervision.

SAFETY AND WARNINGS

- Read and follow the detergent manufacturer's instructions carefully. Instructions on how to use the detergent will be clearly indicated on the pack. Remember to store your detergents out of the reach of children.
- Do not wash an electric blanket in your washer unless the care label specifically states it is safe to do so.
- Do not wash curtains in this washer, as sunlight makes them brittle and they may disintegrate during washing.
- The only user-removable parts of the washer are the inlet hose(s), dispenser drawer and pump filter. No other parts are designed to be removed by anyone other than a Fisher & Paykel trained and supported service technician.
- Do not overload your washing machine beyond its rated capacity.

MODEL CODE	MAXIMUM CAPACITY* (KG)
WH1060S1	10kg

*Capacity refers to the maximum dry weight of items the washer can wash at any one time

Disposal

- When disposing of the washer, it is recommended that the door is removed to avoid children getting trapped inside, and that the electrical cable is cut off close to the washer.

Servicing

- Unauthorized repairs can result in further damage to the product, which can potentially void the warranty. Please refer to the Manufacturer's Warranty for more details.

Light source information

- This product contains a light source of energy efficiency class E. The light source service is limited to Fisher & Paykel Appliances Service Technicians.

SAFETY FEATURES

Keylock

KEYLOCK can be used to lock the buttons on your washer when not in use. This will avoid accidental button pushes. Refer to 'Control panel' for more information.

Add a Garment

The **ADD A GARMENT** button can be used to interrupt the cycle to add or remove a garment at any time during the wash part of the cycle (provided the wash temperature selected is lower than 60°C). Water in the washer will be drained to a level where the door can be opened, if necessary. Refer to 'Control panel' for more information.

Drum light

Your washer has a drum light to help assist you when loading and unloading your washer. When you press **POWER** , the LED light in the drum will turn on. At the end of the cycle, the drum light will turn on again for five minutes to help facilitate unloading.

Door lock

The door of your washer will lock when in **REMOTE MODE** and when you press **▶||** and will stay locked until the washer beeps at the end of the cycle, ensuring safety for you and your family while your washer is operating.

To unlock the door during a cycle



You can open the door to add or remove items during the wash by pressing **▶||**.

The door will remain locked if the temperature inside the washer is above 60°C and/or the water level is above the bottom of the door seal (a warning will be displayed in these circumstances).

Your washer also has the following protective measures:

- Flood protection – turns off valves and turns pump on if a flood condition is detected.
- Out-of-balance protection – stops and redistributes the load if an unbalanced load condition is sensed, and/or slows the spin speed to compensate.
- Excess suds protection – pauses to allow suds to break down before continuing the cycle.

SAFETY FEATURES

Opening the door during a power failure

Do not attempt to do this if the water level in the washer is above the bottom of the door. If there is a power failure during a wash cycle your washer will stop and the door will remain locked.

1

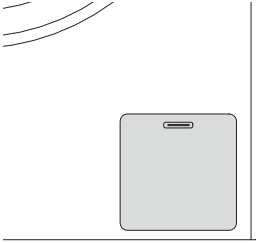

Locate the pump filter cover at the bottom right of your washer.

2

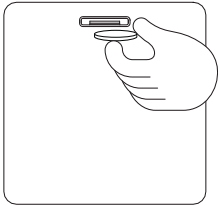

Place a coin or key in the slot and tilt it upwards to lever the cover open.

3

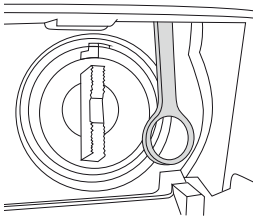

Pull the door release tab down from the ring. Use a screwdriver tip, pen or key to get a good grip.

When power is restored, your washer will resume the interrupted wash cycle. If the cycle doesn't resume automatically, simply press **POWER** ① to restart your washer.

CONTROL PANEL

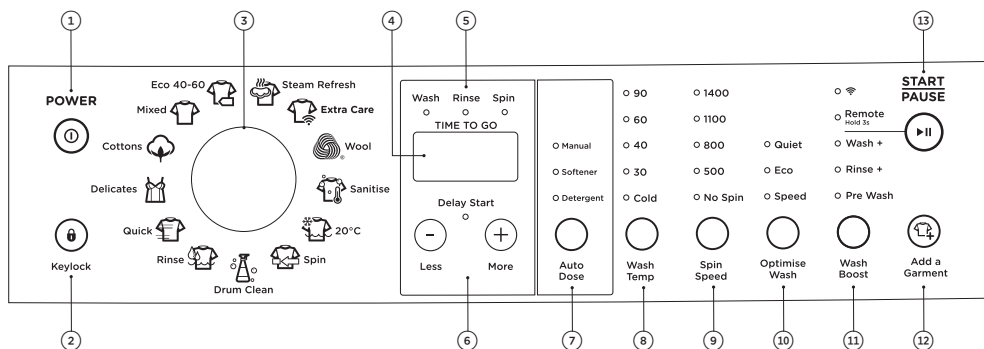

① Power	Press to turn the washer ON/OFF .
② Keylock	Press to disable all buttons on the control panel, except the POWER button. This prevents accidental button presses.
③ SmartTouch™ Control Dial	Rotate to select your desired wash cycle. <ul style="list-style-type: none"> Red LED illuminates to indicate the selected wash cycle.
④ Digital display screen	Shows the following: <ul style="list-style-type: none"> TIME TO GO - the remaining time in the cycle that is currently running. Delayed start time of wash cycle. Notifications if an error is detected or a warning is necessary.
⑤ Progress lights	Indicate the current status of the wash cycle. <ul style="list-style-type: none"> All lights are illuminated at the start of the wash cycle. The light of the current status flashes, and then turns off once completed.
⑥ Delay Start Less/More	Press MORE + to increase and LESS- to decrease the delay start time.
⑦ Auto Dose	Press to select MANUAL or AUTO DOSE dispensing of detergent and softener.
⑧ Wash Temp	Press to increase or decrease wash water temperature.
⑨ Spin Speed	Press to increase or decrease spin speed.
⑩ Optimise Wash	Press to select SPEED , ECO or QUIET .
⑪ Wash Boost	Press to select PRE WASH , RINSE+ or WASH+ .
⑫ Add a Garment	Press to interrupt the wash part of the cycle to add or remove items.
⑬ Start/Pause	Press to start or pause the selected wash cycle. Press and hold this and ADD A GARMENT for three seconds to enable REMOTE (Wi-Fi) mode.

CONTROL PANEL

Add a Garment

Enables you to add or remove items during the wash stage of the cycle, under certain conditions.



1



Press  **ADD A GARMENT**, wait until you hear the door unlock.

2





Press  and the display will flash. Open the door and add or remove items. Close the door and press  to restart the cycle.

Keylock



To turn **KEYLOCK ON** or **OFF** when the washer is powered on:



Press  for three seconds.
When activated, the  is illuminated.

To turn your washer on if **KEYLOCK** is **ON** and the washer is powered **OFF**:





Press **POWER** , then press and hold  for three seconds. This will activate the control panel. Wash cycles and options can now be selected.

If a button is pressed while **KEYLOCK** is activated, beeps will be heard and  will flash.

CONTROL PANEL

If **KEYLOCK** is **ON** and you want to pause your washer:



To pause your washer at any time during the cycle, press and hold  for three seconds then press .

If **KEYLOCK** is **ON** and you want to power **OFF** your washer at any time:



Press **POWER** .

WI-FI CONNECTION & REMOTE MODE

Your appliance may be connected to your home wireless network and operated remotely using the app. Connect your appliance to ensure it stays up to date with the latest software and features.

Getting started

- Ensure your home Wi-Fi network and Bluetooth on your mobile device are turned on.
- You will be given step-by-step guidance on your mobile device.
- It may take up to 10 minutes to connect your appliance.

On your mobile device:



- ① Download the app. Scan the QR code or go to www.fisherpaykel.com/connect
- ② Register and create an account.
- ③ Add your appliance and set up the Wi-Fi connection.

Connecting to your home Wi-Fi

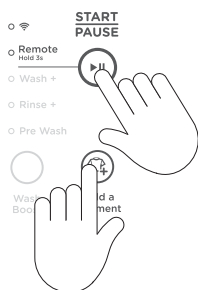

Ensure your appliance is powered on.

Press and hold ►|| and ADD A GARMENT until the LED starts to flash.

Once connected, the LED will stop flashing and remain illuminated. Follow the instructions in the app to complete the connection.

Enabling remote mode



Once setup is complete, press and hold ►|| for three seconds.

REMOTE MODE is now enabled. Certain functions of your appliance can now be accessed via the app.

For safety reasons, when **REMOTE MODE** is enabled the door will be locked. To open the door disable **REMOTE MODE**.

WI-FI CONNECTION & REMOTE MODE

Disabling remote mode



Press and hold ▶|| for three seconds.

Turning off Wi-Fi

1

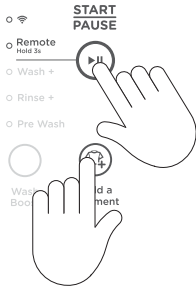

Press and hold ▶|| and  **ADD A GARMENT** buttons for three seconds.

Once Wi-Fi is turned off you must reconnect to your home Wi-Fi and enable **REMOTE MODE** to access certain functions of your washer via the app.

WASH CYCLES

Your washer has a number of wash cycles to suit your laundering needs. Selecting the most appropriate cycle for each particular wash load will help ensure you get the best wash result.

CYCLE	SUB-CYCLE	DESIGNED FOR	MAX. LOAD SIZE (kg)	WASH TEMP (°C)	SPIN SPEED (rpm)
Eco 40-60 ¹	n/a	A cycle for normally soiled cotton items that are washable at 40°C or 60°C, as per the care label. These items can be washed together in the same cycle	10	40	1400
Mixed	n/a	A faster cycle designed for mixed loads with normal soil	10	30 (Cold-60)	1400 (0-1400)
Cottons ¹	n/a	A cycle for normally soiled cotton garments	10	40 (Cold-90)	1400 (0-1400)
Delicates	n/a	A gentle wash with more water to care for lightly soiled delicate garments	4	30 (Cold-40)	500 (0-800)
Quick	Quick 15 ²	A cycle for freshening up of new or very lightly soiled garments	2	30 (Cold-40)	800 (0-1400)
	Quick 30 (default)	A cycle for cleaning lightly soiled loads quickly	6	40 (Cold-40)	1100 (0-1400)
Rinse	n/a	Items that require rinsing and spinning	10	Cold	1400 (0-1400)
Drum Clean	n/a	An extra hot cycle designed to clean your washer	n/a	90	1400 (1400)
Spin	n/a	Spinning wet items	10	n/a	1400 (500-1400)
20°C	n/a	A cold concentrated wash with a fast spin	10	Cold (Cold)	1400 (0-1400)
Sanitise	n/a	An extra hot concentrated wash with multiple rinses	10	75	1400 (0-1400)
Wool ⁵	n/a	An extra gentle wash action for machine washable woollen items that complies with Woolmark Apparel Care criteria	4	40 (Cold-40)	800 (0-800)

WASH CYCLES

CYCLE	SUB-CYCLE	DESIGNED FOR	MAX. LOAD SIZE (kg)	WASH TEMP (°C)	SPIN SPEED (rpm)
Extra Care ³	Synthetics (default)	A normal wash action for your everyday synthetics and poly-cotton blends	4	40 (Cold-60)	1100 (0-1100)
	Easy Iron ⁴	A cycle for normally soiled garments with lower spin speeds to reduce creasing	6	30 (Cold-60)	800 (0-800)
	Sports	A cycle specifically designed for washing sports garments	6	40 (Cold-40)	1100 (0-1400)
	Denim	A normal wash action with low temperatures to care for stretch denim and reduce fading	3	Cold (Cold-40)	1400 (0-1400)
	Silk	An extra delicate wash action with slow spin speed	1	30 (Cold-40)	500 (0-800)
	Heavy	A longer, hotter wash for heavily soiled durable garments	10	60 (Cold-90)	1400 (0-1400)
	Soak	A normal wash action with an additional deep cleaning soak for your mixed everyday loads	10	40 (Cold-60)	1400 (0-1400)
	Allergy	A hot concentrated wash with multiple rinses	10	60 (40-90)	1400 (0-1400)
	Soft Toys	A gentle wash action with a slow spin for soft toys	3-4 toys	40 (Cold-40)	500 (0-800)
	Steam Refresh	n/a	A cycle designed to remove creases and light odours from up to two shirts	2 shirts	n/a

¹ECO 40-60 cycle is recommended for cleaning normally soiled cotton laundry, declared to be washable at 40°C and 60°C together in the same cycle. This programme is used to assess compliance with the EU ecodesign and energy labelling legislation. This programme is the most efficient in terms of energy and water consumption for washing cottons.

²To select **QUICK 15**, turn the dial to **QUICK** and select **SPEED** mode under **OPTIMISE WASH**.

³You can select a different sub-cycle from the default within **EXTRA CARE** by using the app. The cycle selected will become the default **EXTRA CARE** cycle for all future cycles, this can be changed at anytime by using the app.

⁴The **EASYIRON** cycle includes **WRINKLE FREE** the wash will be finished in 15 minutes at the end of the cycle has finished. To remove the load during **WRINKLE FREE**, press ►►.

⁵Woolmark Apparel Care

The wool wash cycle of this machine has been approved by The Woolmark Company for the washing of machine washable wool products, provided that the products are washed according to the instructions on the garment label and those issued by the manufacturer of these washing machines M1766.

The Woolmark symbol is a certification mark in many countries.



DETERGENT AND SOFTENER

De detergent

Your washer requires low-sudsing detergent to prevent oversudsing problems. Low sudsing detergent comes in powder or liquid and is labelled front loading, low suds, high efficiency or HE. Using top loader detergent in your front loader washer may lead to excessive suds formation, which will lengthen the cycle time as the washer waits for the suds to dissolve.

The washer has auto dosing compartments for liquid detergent and fabric softener, and a manual dosing compartment for powder or liquid detergent. Ensure that detergent and softener are filled correctly into their respective compartments.

Do not overfill the detergent compartment. Too much detergent could result in water and detergent spilling onto the floor.

Make sure that the dispenser is completely closed before starting the cycle. Do not open it again until the cycle is complete and the washer has stopped spinning.

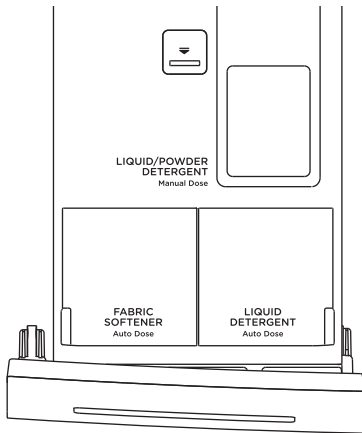

AUTO DOSE LIQUID DETERGENT COMPARTMENT

Stores up to 1100ml (max) of liquid detergent suitable for several washes depending on load size.

AUTO DOSE FABRIC SOFTENER COMPARTMENT

Stores up to 540ml (max) of fabric softener suitable for several washes depending on load size.

MANUAL DOSE LIQUID/POWDER DETERGENT COMPARTMENT

For liquid or powder detergent used for a single wash and when **PRE WASH** is selected.

De detergent advice

If unpleasant odours are noticeable from your washer, it is possible that not enough detergent is being used for the soil level in your loads. Run a **DRUM CLEAN** cycle and either buy a better quality detergent or use a higher dose.

If you find foam leaking from your washer, check if you are using a low sudsing or front loader type detergent. When using **MANUAL DOSE**, check the quantity you are using against the manufacturer's recommended dose on the label. You may need to reduce the amount you are using.

If using **AUTO DOSE** you may need to reduce or increase the amount used. Refer to 'Adjusting the amount of detergent or softener dispensed on Auto dose' for details on how to adjust the dosage.

DETERGENT AND SOFTENER

Fabric softener

The washer will automatically flush the fabric softener during the rinse part of the cycle.

If you wish to use fabric softener we recommend:

- If you fill beyond the **MAX** mark, the fabric softener will be dispensed into the drum prematurely and contribute to a waxy built-up.
- Fabric softener cannot be selected on **ECO 40-60**, **STEAM REFRESH** or the **QUICK 15** cycles.
- The amount of softener dispensed depends on load size.

Fabric softener advice

- Clean your dispenser regularly.
- Clean your washer regularly using the **DRUM CLEAN** cycle.
- Complete wash cycles at a wash temperature of 40°C or above at regular intervals (eg every 5th wash) as washing in cold water increases the chance of a waxy build-up occurring.

Waxy build-up can occur within any washer when fabric softener comes in contact with detergent. This build-up is not brought about by a fault in the washing machine. If allowed to build up in the washer it can result in stains on clothes and an unpleasant smell in your washer.

Auto Dose

AUTO DOSE DETERGENT is the default setting for all wash cycles (except **WOOL** and **DRUM CLEAN**). Only liquid detergent can be used for **AUTO DOSE**. **AUTO DOSE** will automatically dispense the right amount of liquid detergent and fabric softener (optional) per wash cycle.

If you wish to add fabric softener, you need to select **SOFTENER** using the **AUTO DOSE** button.

- Auto dosing of fabric softener can be used in combination with both auto and manual dosing of detergent.

We do not recommend storing laundry wash products containing acetic acid, eg vinegar, in the **AUTO DOSE** compartments.

If using Auto Dose

Fill the **LIQUID DETERGENT** compartment up to the **MAX** level indicated.

Fill the **FABRIC SOFTENER** compartment up to the **MAX** level indicated.

If softener is selected, the washer will automatically dispense the fabric softener during the rinse part of each cycle.

DETERGENT AND SOFTENER

Manual Dose

Liquid or powder detergent can be used for **MANUAL DOSE**.

Where a detergent for a certain fabric and/or cycle is recommended, **MANUAL DOSE** is the default setting (eg **WOOL** and **DRUM CLEAN**).

If using Manual Dose

MANUAL DOSE can dispense powder or liquid detergent for washing.

Follow the instructions stated on the detergent label as a guide when determining the correct dosage of detergent suitable for your wash load.

The detergent dosage needed may vary depending on the amount of soil, size of the load and the water quality.

WASH PREPARATION

Sorting

Sort items according to colour, fabric type, and soil type. Wash fine, delicate fabrics separately from thick, heavy fabrics. Always separate coloured items from whites, especially when they are new. Colour run could be an issue if you wash items at higher temperatures. Some soils, like mud and blood are best washed in cold water. Oily soils (eg some foods and marks on shirt collars) are best washed in warm water. The care label will advise on how the garment should be washed.

Before you load

- Check pockets for items that could damage your clothes or get caught in the washer.
- Close zippers, hooks and eyes, and other fastenings (ie fasten the opening of duvet/ doona covers), and remove loose bra wires. All these can damage both your washer and your clothes.
- Place delicate items, such as lingerie, in a mesh laundry bag before placing in the washer.
- Pre-treat any stains, taking care not to spray pre-treaters on your washer as they can cause damage to the plastic surfaces.

Loading

To save on energy and water consumption, your washer will be most efficient when washing larger loads. To achieve this, try to fill your washer to the maximum load size for the cycle selected (refer to “Wash cycles”).

WASH PREPARATION

ITEMS/WASH REQUIREMENTS	SUGGESTED CYCLE AND OPTIONS	SUGGESTED TEMPERATURE
Towels	Cottons, 1400 or 1100 rpm spin	30°C or 40°C
Sheets, pillowcases	Mixed, 1400 or 1100 rpm spin	30°C or 40°C
Bulky items – doonas, duvets, sleeping bags	Delicates, 800rpm	30°C or 40°C
Shirts, pants, other creasables	Easy Iron, 800 rpm	30°C or 40°C
Woollens	Wool, 500 rpm	30°C or 40°C
Delicate garments – blouses & dresses	Delicates	30°C
Extra delicate fabrics like lace	Delicates	30°C
Silk garments	Delicates	30°C
Jeans	Mixed or Extra Care – Heavy	Cold or 30°C
Highly coloured items	Mixed	Cold or 30°C
Whites, cotton items	Cottons, 1400 or 1100 rpm spin	40°C or 60°C
Sensitive skin or extra rinsing requirements	Cottons, Rinse+	40°C
Asthma/allergies	Cottons, Rinse+	60°C
Handkerchiefs, nappies, bedding and facemasks	Sanitise	75°C
Lightly soiled items	Quick – Quick 30 or 15	30°C
Muddy, sandy or linty items	Mixed	Cold
Unpleasant odour in the washer drum	Drum Clean	90°C
Items made of blended fibres (eg polyester cotton)	Mixed	40°C
Sportswear	Sports	30°C or 40°C
Soft toys	Extra Care – Soft Toys	40°C
Heavily soiled items	Extra Care – Heavy	40°C

GETTING STARTED QUICKLY

1



Press **POWER** ① to activate your washer.

2



Select your desired wash cycle by turning the Control Dial. The wash cycle icons will illuminate as you turn the dial showing which cycle is selected, along with the default wash cycle settings.

3

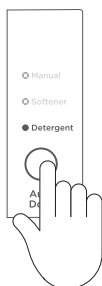

Select your desired detergent/softener dosing mode by pressing **AUTO DOSE**.

4

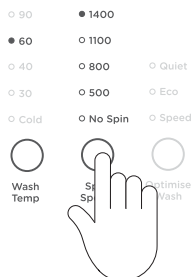

Customise your wash as needed by selecting specific temperature and spin speeds. Refer to 'Customising a wash cycle' for more information.

GETTING STARTED QUICKLY

5

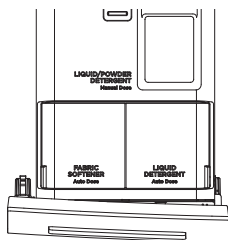

Open the detergent drawer.

Fill the liquid dispenser compartment, or if using **MANUAL** dispensing, add detergent to the manual dispensing compartment.

Only add detergent to the **MANUAL** dispensing compartment when using **MANUAL** dispensing.

6



Press ▶|| to start the cycle. The washer will start to fill with water and select the correct wash action for your load.

7



Press and hold 🔒 for three seconds to lock the buttons on the control panel, preventing them from being activated accidentally.

CUSTOMISING A WASH CYCLE

Delay Start

You can delay the start of the wash cycle between 15 minutes and 12 hours. This can be useful to time your washing to finish when you arrive home from work, or to start once you have finished in the shower.

1

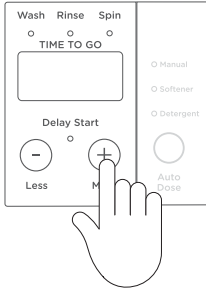

Press **MORE +** to increase the delay time, and **LESS -** to decrease the time, or turn **DELAY START** off.

2



Press **▶||** to confirm your selection and start the countdown. The display screen will show the time until the cycle is set to begin.

Avoid using **DELAY START** for damp, non-colourfast items as this may cause dye run to occur.

Auto Dose

A red LED will illuminate to indicate which **AUTO DOSE** options have been selected.

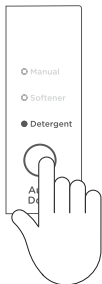

Press **AUTO DOSE** to activate your preferred option: **DETERGENT**, **DETERGENT** and **SOFTENER**, **MANUAL**, or **MANUAL** and **SOFTENER**.

CUSTOMISING A WASH CYCLE

Adjusting the amount of detergent or softener dispensed on Auto dose

The default amount of detergent or softener used for **AUTO DOSE**, for a given cycle, can be adjusted to any of the following levels: *1, 2, 3, 4* and *Hi*.



Turn the dial to select the wash cycle you want to adjust the **AUTO DOSE** level for, eg **MIXED**.

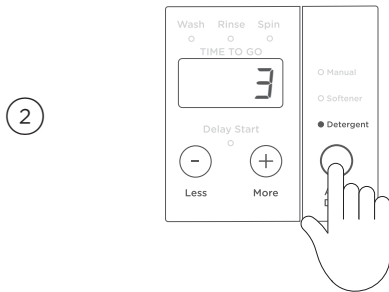

Press **AUTO DOSE** to select **DETERGENT** or **SOFTENER**, depending on which requires adjustment.

Press and hold **AUTO DOSE** for three seconds, **SET** and then the default setting of **3** will be displayed.

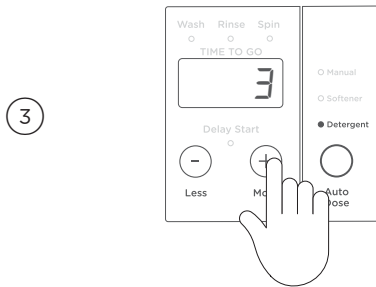

Press **MORE +** or **LESS -** to increase or decrease the amount of detergent or softener used for **AUTO DOSE**.

If required, press **AUTO DOSE** again to adjust softener.

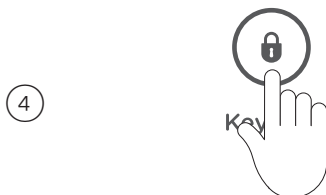

Once you have completed the adjustment, ensure the **AUTO DOSE** options you want saved as the default are selected, then press **Key** to store your adjustment for the selected cycle. A long beep will sound to confirm that your changes have been saved.

Refer to 'To save a customised cycle' for details on changing the default auto dose option for a cycle (**AUTO DOSE**, **MANUAL**, **SOFTENER**).

CUSTOMISING A WASH CYCLE

Wash Temp

Your washer has five wash temperatures (COLD, 30°C, 40°C, 60°C and 90°C).

Some temperatures are not available on some cycles as a safeguard for your clothes (eg temperatures above 40°C on the **DELICATE** cycle).

The washer will fill with both hot and cold water (if possible) to achieve the selected wash temperature. If required, ie for cold supply or cold connection only, the washer will heat the water to the selected temperature.

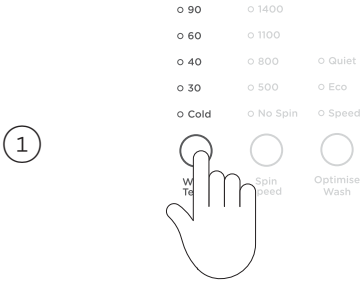

Press the **WASH TEMP** button to increase or decrease the wash temperature.

Spin Speed

Your washer offers five spin speeds: 500 rpm, 800 rpm, 1100 rpm and 1400 rpm, **NO SPIN**.

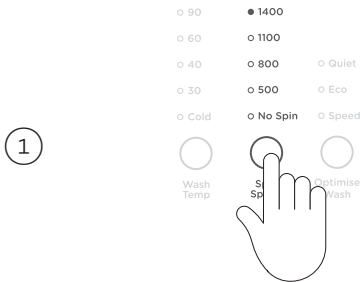

Press **SPIN SPEED** to select the required spin speed for your load.

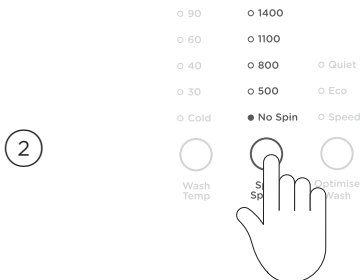

Selecting **NO SPIN** will end the cycle after the rinse, allowing you to remove items you wish to drip dry.

The washer will complete the spins that are within the wash and rinse portions of the cycle; only the final spin will not be completed.

CUSTOMISING A WASH CYCLE

Optimise Wash

Your washer offers three optimise wash modes – **SPEED**, **ECO** and **QUIET** – allowing you to reduce noise, save water and energy or save time. For clothes care reasons not all options are available on all cycles.

Speed

A special feature designed to offer a shorter cycle whilst maintaining wash performance. This option can be selected on **MIXED**, **COTTONS**, **EXTRA CARE - HEAVY** and **EASY IRON** cycles. A number of factors can influence the amount of time saved on a cycle, including the load size, cycle chosen, water flow rate and load distribution during spin.

Eco

Use the **ECO** option to save water and energy. Selecting **ECO** will reduce the wash temperature slightly and alter the wash and rinse programming.

- **SPEED** and **ECO** cannot be selected together.
- **ECO** will not be available if **PRE WASH** or **RINSE+** have been selected.

Quiet

Use **QUIET** mode when washing at night, if your washer is installed on a wooden floor, and/or when noise is a concern. This mode reduces the spin speed to limit the level of noise emitted, but may increase the level of moisture remaining in the load. This mode includes **WRINKLE FREE**, the washer will tumble the clothes once every 15 minutes after the cycle has finished. The cycle icon and **▶II** will flash indicating **WRINKLE FREE** is operating, to remove the load during **WRINKLE FREE**, press **▶II**.

Wash Boost

Your washer offers three wash boost modes – **PRE WASH**, **RINSE+**, **WASH+** – allowing you to add an extra short wash for extra dirty loads, an extra rinse to your cycle, or an increase to the wash time for dirty loads.

Pre Wash

Your washer will start with a short wash in cool water to remove excess soil. The washer will drain and then fill at the selected temperature for the main wash. **PRE WASH** cannot be selected after a wash cycle has been started or if **ECO** has been selected. Use liquid or powdered detergent in the **MANUAL** compartment. The compartment is flushed at the start of the cycle.

Rinse+

If you have a particularly dirty load, or you have sensitive skin and wish to give your clothes an extra rinse, select **RINSE+** from the **WASH BOOST** options. Your load will undergo an extra rinse to get rid of any residual detergent or soil in the items.

RINSE+ will not be available if the **ECO** option has been selected.

Wash+

WASH+ allows you to increase the wash time for heavy soiled items. The increase in wash time gives the load the right amount of tumbling to remove the soil from items that might need it.

CUSTOMISING A WASH CYCLE

To save a customised cycle

You can program your washer to remember the wash options you prefer for each wash cycle. For instance, you may want to set the **MIXED** cycle to default to **40°C** or set the **EXTRA CARE HEAVY** cycle to include **WASH+** or **RINSE+**.

1



Press **POWER** ① to activate your washer.

2



Turn the dial to select the wash cycle you wish to customise, eg **MIXED**.

3

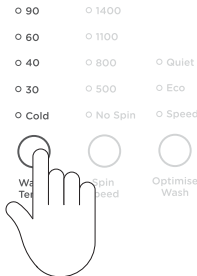

Press and hold the button of the option you want to customise, eg **WASH TEMP** for three seconds. You will hear two quick beeps and the wash cycle icon will flash. The screen will display **SEL**.

CUSTOMISING A WASH CYCLE

4



Select your preferred setting for the option, then press  to save. A long beep will sound to confirm that your changes have been saved.

5



Continue to select any other options you wish to customise for this cycle. Press  to save your customised cycle.

To change your customised wash cycle simply repeat these steps.

FACTORY RESET

You can reset your washer to factory default settings by following the steps below.

To reset your washer to factory default settings:



Select the **SPIN** cycle.

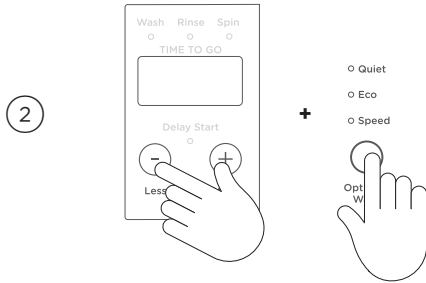

Press **MORE +**, **LESS -** and **OPTIMISE WASH** buttons together for three seconds, *dEF* will appear on the screen and the washer will beep.

Your washer will now be reset to factory default settings.

CARING FOR YOUR WASHER

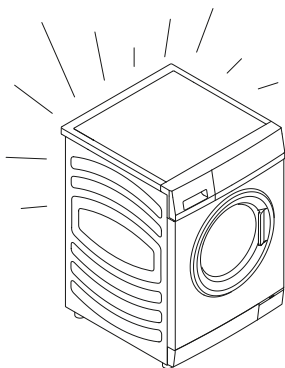

When you have finished using your washer

- Turn off the taps to prevent the chance of flooding should a hose burst.
- Unplug the washer from the power socket.

Cleaning your washer

Before you start cleaning your washer, ensure that it is disconnected from the power (ie unplug the washer from the power socket).

Aside from the detergent dispenser, water hose(s), and the pump filter, no other parts are designed to be removed from the washer for cleaning. Do not attempt to remove any other part of the washer.

Cleaning the control panel and outer surfaces of the washer

Use a soft damp cloth to wipe all surfaces, and wipe dry. Avoid using chemical or scouring cleaners, as these will damage the paint and plastic surfaces of your washer.

Cleaning the dispenser drawer

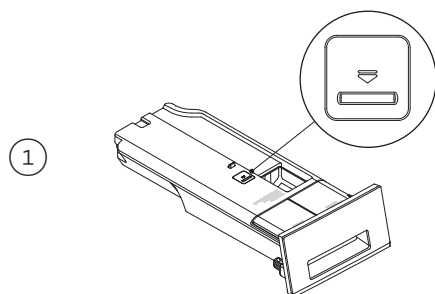

To remove the dispenser drawer from the washer, pull the dispenser drawer open, push down on the tab to the left of the **MANUAL DOSE** compartment and pull the dispenser drawer out from the washer.

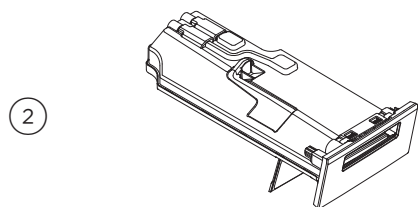

To empty the dispenser drawer, turn the dispenser drawer upside down in the sink and allow the leftover laundry liquid from the **AUTO DOSE** compartments to drain.

CARING FOR YOUR WASHER

3

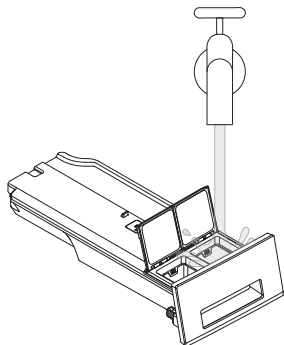

To clean the dispenser drawer, fill the compartments with warm water and shake lightly to clear residue.

Use a descaling agent and brush to remove stubborn residue and limescale.

Drain all water from the compartments before re-fitting the dispenser drawer to the washer.

4

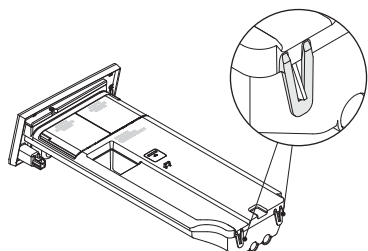

To disassemble the dispenser drawer further for cleaning, unhook the two clips at the rear of the dispenser to remove the cover.

Ensure the dispenser drawer is correctly reassembled before re-fitting to the washer.

Cleaning the drum and the door

- Use a soft damp cloth to wipe the door, cleaning any water marks or residue off it.
- Wipe the rubber seal around the door. Remove any items or lint accumulating in the bottom of the seal catchment and wipe out any water accumulated here. If this is not cleaned out, unpleasant odours will develop.
- If the drum has any residual dirt or lint stuck to it, remove this and wipe the drum clean. Do not leave any metal objects in the drum as these may rust and cause staining.

Leave the door to your washer open when it is not in use to allow the washer to dry out, otherwise it will develop unpleasant odours. When leaving the door open like this, it is extremely important that children and pets are kept away from the washer so they cannot be accidentally trapped inside it.

Cleaning the hose(s)

Each hose has a filter in it, preventing any solid contaminants in the water entering your washing machine. Occasionally you should disconnect the water inlet hose(s) where they connect to the tap(s), check these for any build up of dirt and wash this out.

CARING FOR YOUR WASHER

Cleaning the inside of your washer

It is important that you regularly clean the inside of your washer using the **DRUM CLEAN** cycle. After 100 cycles, a notification will pop up on the display screen to remind you to clean your washer.

If your washer starts to smell this is a sign that you should complete a **DRUM CLEAN** cycle. We recommend that you do not have any items in the washer when you run this cycle.

1

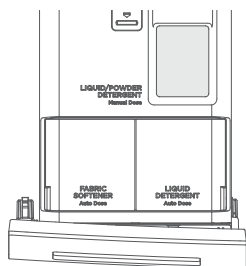

Add the washing machine cleaner directly into the **MANUAL DOSE DETERGENT COMPARTMENT**. Follow the manufacturer's instructions.

2

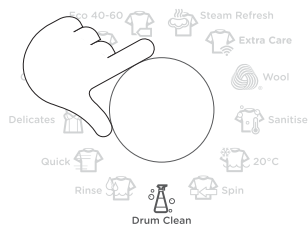

Press **POWER** ① to turn your washer on and select the **DRUM CLEAN** cycle.

3



Press ►|| to start the cycle.

CARING FOR YOUR WASHER

Cleaning the pump filter

Check and clean the pump filter regularly to maintain optimum performance. Some water may leak from the filter when it is removed. Turn the washer off at the wall before cleaning this part.

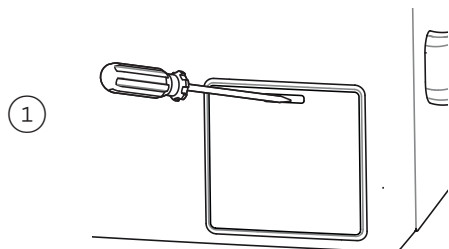

Insert a flathead screwdriver into the slot and lever the cover open.

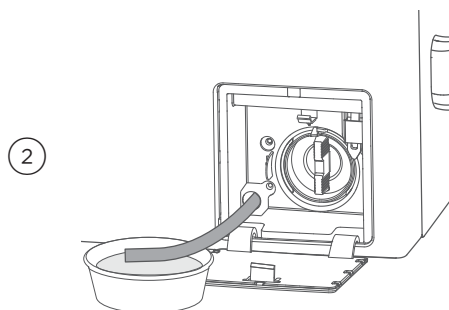

Unhook the outlet hose and pull it out (approximately 150mm). Remove the plug and allow any water (approximately 250ml) to drain into a shallow dish.

After draining, replace the plug and refit the hose into the housing.

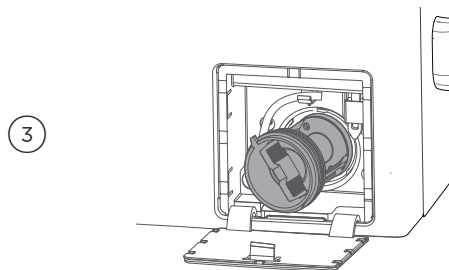

Turn the filter anti-clockwise to remove. Clean and rinse under a tap. Check and clear the cavity behind the filter. Remove any obstructions and check the impeller behind the filter moves freely.

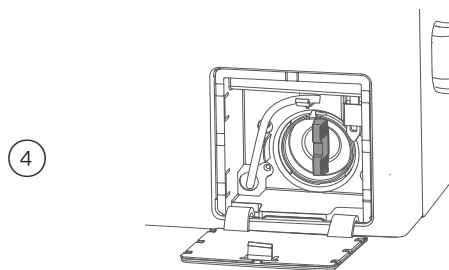

Refit the filter and turn clockwise to secure. The handles should be in the vertical position. Do not use excessive force to tighten.

To avoid leaks, ensure filter and hose are correctly in place before running another cycle.

CARING FOR YOUR WASHER

Products that might damage your washer

- Concentrated bleaches, laundry pre-soakers/sanitiser, stain removers and hydrocarbon solvents (eg petrol and paint thinners) can cause damage to the surfaces eg control panel, and components of your washer.
- Be careful when washing garments stained with solvents as they are flammable. DO NOT put them in your dryer.
- Use of dyes in your washer may cause staining of the plastic components. The dye will not damage the washer but we suggest you thoroughly clean your washer afterwards. We do not recommend the use of dye strippers in your washer.
- Nappy sanitiser and bleach are very corrosive to metal surfaces. DO NOT tip the contents of a nappy bucket into your washer. Rinse and wring items out thoroughly before placing them in the washer.

Moving your washer

Make sure any water in the washer is drained out. This can be done by cleaning out the pump filter, refer to 'Cleaning the pump filter'.

Saving water, energy and the environment

Water efficient washing machines will save you money, but it is also worth thinking about energy use, recycling water and the environment. Some options to consider are:

- Turn the washer off at the wall when not in use.
- Turn off the taps when not in use.
- Select cooler wash temperatures.
- Wash full loads rather than several smaller loads.
- Use the **ECO** wash function (where available).
- Follow instructions on the detergent packet or bottle – do not overdose.
- Use concentrated detergent – it costs less per wash.
- Consider re-using the washing machines grey water on the garden or for flushing your toilet – more information can be found on [government websites promoting energy and water saving](#).

BEFORE YOU CALL FOR SERVICE

User warnings

Your washer is capable of self diagnosis and may sound a series of beeps and display a notification or warning to inform you when there is a problem. In most cases you will be able to address the problem the washer is alerting you to. Check this chart before you call for service.

PROBLEM	DISPLAYED AS	WHAT TO DO
Keylock is activated	KEY LOC	Press and hold  for three seconds.
Pump filter is blocked	CLF FLTR	Clean the pump filter.
The washer is not getting any water	n0 ERR	<p>Check the tap(s) have been turned on.</p> <p>If there is no hot water connection the washer will heat the water itself, but there must be a cold water connection to the cold valve.</p> <p>Check the hose connections. If the cold water supply is connected to the hot valve and there is no connection to the cold valve the washer will not fill.</p> <p>Check the inlet hose(s) filters are not blocked, the hose(s) are not kinked and are attached correctly.</p> <p>Check that the drain hose is not too low or pushed into the standpipe too far. This will cause the water to siphon out of the washer.</p> <p>Check that the cold water temperature does not exceed the 35°C temperature requirement.</p> <p>Check the water flow rate. It maybe too low.</p>
The washer is out of balance	ouE DF BAL	<p>The wash load has gone out of balance at some point during the cycle. Press ► to stop the message. You may notice the load feels wetter than usual, as the washer has adjusted the spin speed to compensate for the out of balance. If you want to improve the dryness of the load, manually re-distribute the load and remove items if necessary. Close the door, adjust the spin speed if necessary and press ► to start the washer.</p> <p>Check the washer is level.</p>

BEFORE YOU CALL FOR SERVICE

PROBLEM	DISPLAYED AS	WHAT TO DO
The washer has too many suds	<i>Sud LOC</i>	<p>Washer will stop and flash <i>Sud LOC</i> while waiting for suds to dissipate. The washer will not beep during this time. When the suds have dissipated the washer will automatically restart. If a suds event has occurred during a cycle the washer will also display this warning at the end of the cycle, to alert you that this has occurred. This may help to explain any reduction in performance.</p> <hr/> <p>Check you are using a detergent suitable for front loaders.</p> <hr/> <p>Check you are not overdosing the detergent.</p> <hr/> <p>Check the standpipe height for the drain is a minimum of 600mm.</p>
Door is locked	<i>door Locked</i>	<p>The temperature in the drum is over 60°C therefore it is not safe to open the door. Wait until the temperature drops below 60°C.</p> <hr/> <p>Check the water level in the drum. If the level is above the bottom of the door seal, the door cannot be opened. Use the ADD A GARMENT button if you wish to add or remove items</p> <hr/> <p>If the drum is still moving, wait for it to stop before attempting to open the door.</p>
Door is open	<i>door OPEN</i>	<p>Close the door fully and press ▶ .</p> <hr/> <p>Try opening and closing the door again.</p> <hr/> <p>Reposition the load, make sure the load is correctly in the drum and that protruding items are not stopping the door from closing.</p>
Door is open	<i>close door</i>	<p>Close the door fully.</p> <p>This warning will appear you are attempting to enter REMOTE MODE and the washer door is open. The door must be closed for REMOTE MODE to be enabled.</p>

FAULT CODES



If a continuous series of beeps sounds, all the lights turn off on the control panel and a number appears on the display, a fault has occurred. The washer automatically enters this mode when there is a fault. The word *FAULT* will be shown in the control panel display followed by a number (refer to example shown here). To stop the beeps, touch any button then perform the following steps:

- ① Turn your washer off at the power point.
- ② Wait one minute and turn it back on.
- ③ Check your washer is correctly levelled. Refer to your installation guide.
- ④ Remove your wash load.
- ⑤ Perform a **RINSE** cycle.
- ⑥ If the fault re-occurs repeat steps ① and ②.
- ⑦ If the washer will still not work you will be required to call a Fisher & Paykel trained and supported service technician to arrange service, refer to 'Customer Care' for details. Record the fault code number displayed and the serial number of your washer (located above the door opening when the door is open) before calling. The fault code will indicate to the repairer what the problem could potentially be.

If a fault code is being displayed, you can still turn your washer off by pressing **POWER** ① .

TROUBLESHOOTING

The following is a list of problems you may encounter when using this appliance and some suggestions that may help to correct the problem. If you still have problems, contact your Fisher & Paykel trained and supported service technician.

PROBLEM	POSSIBLE CAUSES	WHAT TO DO
Washer not turning on	Power not switched on at the wall.	Switch the power on at the wall. Press POWER  .
	Household power supply not working.	Try plugging in another electrical appliance.
Pressing ► does not start the fill	Keylock may be activated.	Press and hold  for three seconds.
	Washer door not closed properly.	Open and reclose door.
	The washer has detected a fault.	Check if a code is being displayed on the control panel, refer to 'Fault codes'.
	Hot and cold taps not turned on.	Check that both hot and cold taps are turned on (if using cold inlet only ensure inlet valve cap is installed on the hot valve on the washer).
	Hot and cold taps not connected to the corresponding valve on the washer.	Check the cold tap is connected to the cold valve on the washer and the hot tap is connected to the hot valve.
	Blocked hose filters.	Check the tap end of the inlet hose(s) for blockages.
	Inlet hose(s) leaking, twisted or damaged.	Check the inlet hose(s) for leaks or damage. Check that the inlet hose(s) are not twisted.
	Faulty water supply.	Check tap(s) that aren't connected to the washer are working.
Washer stops working mid cycle	Delay start maybe set.	Refer to 'Delay Start'.
	The washer has detected a fault.	Refer to 'User warnings' or 'Fault codes'.
	Power or water failure.	Check the power and/or water is working correctly.
	Washer has been paused.	Press ► to continue.
Washer drains while filling	Oversudsing.	Washer is waiting for suds to dissolve before continuing the cycle.
	Drain hose too low.	Ensure the height of the drain hose is at least 600mm from the floor level, refer to your installation guide.
	Drain hose sitting in water.	Clear the drain.

TROUBLESHOOTING

PROBLEM	POSSIBLE CAUSES	WHAT TO DO
Washer is not draining	Drain hose blocked.	Clear the drain hose.
	Pump filter blocked.	Clear the pump filter, refer to 'Cleaning the pump filter'.
	Drain hose higher than 1000mm above floor level.	Lower the level of the drain hose, refer to your installation guide.
Filling continuously	Drain hose not connected to standpipe, tub or spigot.	Connect drain hose correctly, refer to your installation guide.
	Washer is siphoning.	Ensure standpipe or tub is at least 600mm from the floor level.
Poor rinsing	Incorrect detergent used.	Use low sudsing, front loader detergent only.
	Too much detergent used.	Ensure the correct dose of detergent is used for the load size and soil level refer to 'Detergent and softener'.
Not spinning properly	Load has gone out of balance.	The wash load has gone out of balance during the spin. If you want to improve the dryness of the load, manually re-distribute the load and remove items if necessary. Close the door and select the SPIN SPEED , adjust the spin speed if necessary and press ► to start the washer.
	Suds build up.	Check the amount of detergent used, reduce if necessary.
Too many soap suds	Incorrect type of detergent used.	Use low sudsing, front loader detergent only refer to 'Detergent and softener'.
	Too much detergent used.	Ensure the correct dose of detergent is used for the load size and soil level refer to 'Detergent and softener'.
	Inlet water pressure/ flow rate too low.	Ensure correct inlet water pressure and flow rate as per the installation guide.
Small puddle of water from under the washer	Inlet hose(s) or drain hose leaking.	Check inlet hose(s) and the drain hose are correctly attached and not damaged.
	Lots of suds.	Suds may have leaked and then dissolved.
	Dispenser compartments blocked.	Refer to 'Cleaning the dispenser drawer'.
	Dispenser drawer not fully closed.	Close dispenser drawer fully and ensure it remains closed during the cycle.
	Damage to door seal.	Check seal inside door for damage. If it sustains any damage it will need to be replaced.

TROUBLESHOOTING

PROBLEM	POSSIBLE CAUSES	WHAT TO DO
Cycle time longer than usual / inaccurate adjustment of time remaining during cycle	Cycle time is approximate.	Cycle time is influenced by a number of factors refer to 'Wash cycles'.
	Low water pressure or flow rate.	Ensure that inlet hose filters are not blocked.
	Out of balance or oversudsing.	Recovery from out of balance or oversudsing will extend cycle time refer to 'Caring for your washer'.
	Washing a large load.	Be aware that it will take longer for the washer to fill.
	Selecting various options.	Be aware that some options will extend cycle time.
Detergent or fabric softener remaining in manual dose dispenser at the end of the cycle	Dispenser drawer not properly closed or was opened part way through the cycle.	Ensure the dispenser drawer is fully closed at the start of the cycle and remains closed throughout the cycle.
	Dirty or blocked dispenser.	Clean the dispenser drawer. Refer to 'Cleaning the detergent dispenser drawer'.
	Liquid sitting at the MAX level at the end of the cycle indicates a blockage.	Clean the fabric softener dispenser compartment, refer to 'Cleaning the dispenser drawer'.
	Dispenser over loaded with detergent.	Clean out remaining detergent, Refer to 'Cleaning the detergent dispenser drawer'.
	Composition of the powder detergent makes it difficult to dispense.	Dissolve detergent with water to aid with dispensing.
Washing very wet at the end of the cycle	Cycle selected not appropriate.	Particularly short or delicate cycles have shorter spins which can result in wetter washing at the end of the cycle.
	Incorrect spin speed for load selected.	Select a faster spin speed.
	An out of balance load has occurred.	The washer compensates for the out of balance by using a lower spin speed, to reduce noise and potential damage to the product.
Vibrating	Transit bolts left in place.	Ensure transit bolts are removed prior to use of the washer, refer to your installation guide.
	Washer may not be level.	Ensure washer is installed on an appropriate surface and levelled correctly, refer to your installation guide.
	Load is out of balance.	Wash an average sized load rather than a smaller load or a single item. Washing one item at a time is not recommended as it is difficult for the washer to balance a single item during spin.

TROUBLESHOOTING

PROBLEM	POSSIBLE CAUSES	WHAT TO DO
Creasing	Washer overloaded.	Do not overload the washer.
	Incorrect cycle for load type.	Use the EASY IRON, DELICATE or STEAM REFRESH cycle for creasable items.
	Spin speed too fast.	Select a slower spin speed.
	Wet clothes left in washer or laundry basket.	Laundry left sitting wet is more likely to crease. If not removing clothes from washer immediately at end of cycle. Do not leave wet washing sitting in a washing basket.
	Wash temperature too hot for load type.	Select a lower wash temperature. Check items care label for correct care. Check the hot and cold taps are connected to the correct valves, refer to your installation guide.
	Items not sorted correctly.	Sort load so that items of similar weight are washed together.
Poor soil removal	Incorrect wash cycle selected.	Select a wash cycle that is appropriate for the amount of dirt, refer to 'Wash cycles'.
	Insufficient detergent.	If using MANUAL DOSE ensure the correct dose of detergent is used for the load size and soil level, refer to 'Detergent and softener'. If using AUTO DOSE refer to 'Adjusting Auto Dose'.
	Washer overloaded.	Ensure the washer is not overloaded in terms of its capacity or the cycle selected, refer to 'Loading'.
	Items require a longer wash time.	Select WASH+ or PRE WASH option.
	Load was particularly dirty.	Select the PRE WASH option for particularly dirty loads, refer to 'Customising a wash cycle'.
	Items not sorted correctly.	Wash heavily and lightly soiled garments separately.
	Washer dirty from previous wash.	After washing particularly dirty clothing, we recommend putting the washer through a RINSE cycle once the load has been removed. This washes away any remnants of dirt that could affect future wash performance.
	Incorrect wash temperature selected in relation to the type of soil.	Select a wash temperature suitable for the type of soil, eg warm for greasy soils, cold for muddy soils. Increasing the wash temperature generally improves soil removal and overall wash performance.
		Ensure garments can be washed at the increased temperature.

TROUBLESHOOTING

PROBLEM	POSSIBLE CAUSES	WHAT TO DO
Dye transfer	Coloured items not washed separately from white/light coloured items.	Remember to separate whites and colours.
	New or non-colourfast items not washed separately.	Wash non-colourfast items separately and select COLD wash temperature.
	Wet items have been left sitting for too long.	Remove items from washer as soon as the cycle is finished.
	Wash temperature.	Consider the wash temperature you select for your coloured items. Lower the temperature if you are concerned.
Black or grey marks on clothes	Incorrect amount of detergent.	Ensure the correct dose of detergent is used for the load size and soil level, refer to 'Detergent and softener'.
	Washer needs to be cleaned.	Empty the washer and complete a DRUM CLEAN cycle, refer to 'Cleaning the drum and the door'.
Tangling	Items not sorted correctly.	Separate larger items from smaller items.
	Washer loaded incorrectly.	Load items loosely and individually into the washer, ie not folded.
	Incorrect cycle for load type selected.	Use the EASY IRON or STEAM REFRESH cycle for items that crease easily.
	Overloaded in terms of its capacity or the cycle selected.	Refer to wash cycles for recommended maximum load size.
	Delicate items.	Wash pantyhose, bras and any other delicate items prone to tangling in a mesh laundry bag.
Washer smells	Not using enough detergent for the soil level in your loads.	Run a DRUM CLEAN cycle.
		Buy a better quality detergent or use a higher dose. Different detergents have different cleaning chemicals, consider alternating detergents to help remove odour.
Wet patches on clothes/items	Clothes are slightly damp from the steam.	It is normal for items to be damp after using the STEAM REFRESH cycle, this helps to remove the wrinkles. Remove the items from the washer immediately at the end of the cycle and hang up to dry.

ENERGY CONSUMPTION & CYCLE TIMES

Information on product Energy Labeling and Eco-design can be found in the European Product Database (EPREL) at the following link <http://eprel.ec.europa.eu/>.

You will be asked to enter the model identifier, this information can be found on the rear of the washer and/or above the drum, below the control panel (when the door is open).

The below values are indicative only.

CYCLE	SUB-CYCLE	LOAD SIZE* (KG)	SPIN SPEED (RPM)	REMAINING MOISTURE CONTENT (%)	MAXIMUM TEMP (°C)	ENERGY (KWH)	WATER CONSUMPTION (L)	DURATION (H:MM)
Eco 40-60	n/a	2.5	1400	57	24	0.290	32	2:59
		5	1400	55	30	0.650	44	2:59
		10	1151	61	31	0.960	79	3:59
Cottons	Cotton	10	1400	50	60	2.110	129	2:15
Mixed	Mixed	10	1400	55	30	0.440	89	0:59
Mixed	Heavy	10	1400	55	60	2.280	140	2:03
20°C	n/a	10	1400	55	20	0.430	78	2:06
Quick	Quick 30	6	1100	60	40	0.190	67	0:30

ENERGY CONSUMPTION (KWH)

Off-mode	0.49
----------	------

Left-on mode	0.49
--------------	------

MANUFACTURER'S WARRANTY

For details of your 5 year manufacturer's warranty and contacts for servicing, please refer to your separate service & warranty document online at fisherpaykel.com/uk.

This product has been designed for use in a normal domestic (residential environment). This product is not designed for any commercial use. Any commercial use by the customer will affect this products Manufacturer's Warranty.

For spare parts, please contact Fisher & Paykel Customer Care. Spare parts are available for all Fisher & Paykel products for a minimum period of 10 years from the date of manufacture.

CUSTOMER CARE

Before you call for service or assistance

Check the things you can do yourself. Refer to your User guide and check:

- ① Your product is correctly installed.
- ② You are familiar with its normal operation.
- ③ You have read the 'Before you call for service', 'Fault codes' and 'Troubleshooting' sections.

If after checking these points you still need assistance or parts, please refer to your nearest Fisher & Paykel trained and supported service technician, Customer Care, or contact us through our website fisherpaykel.com.

In UK if you need assistance

Call the Fisher & Paykel Customer Care Centre and talk to one of our Customer Care Consultants.

Toll Free: 08000 886 605

Website: fisherpaykel.com

Postal address:

Fisher & Paykel Appliances Ltd,
Turing House, Ortensia Drive,
Milton Keynes MK17 8LX

In Ireland if you need assistance

Call the Fisher & Paykel Customer Care Centre and talk to one of our Customer Care Consultants.

Toll Free: 1800 625174 or 01 807 7960

Website: fisherpaykel.com

Postal address:

Fisher & Paykel Appliances Ltd,
Unit 2D Corporate Park,
Swords Dublin

CUSTOMER CARE

If you need service

Fisher & Paykel has a network of Fisher & Paykel trained and supported service technicians that can carry out any service necessary on your appliance. Our Customer Care Centre can recommend a Fisher & Paykel trained and supported service technician in your area. Or you can book one online at fisherpaykel.com/uk/help-and-support or fisherpaykel.com/ie/help-and-support

If you call, write or contact us via our website please provide:
your name and address, model number, serial number, date of purchase and a complete description of the problem. This information is needed in order to better respond to your request for assistance.

Product details can be found on the rear of the washer and/or above the drum, below the control panel (when the door is open).

Registration

Register your product with us so we can provide you with the best service possible. To register your product visit our website: fisherpaykel.com/register

Complete and keep for safe reference:

Model _____
Serial No. _____
Purchase Date _____
Purchaser _____
Dealer _____
Suburb _____
Town _____
Country _____

EUROPEAN DIRECTIVE 2012/19/EU ON WASTE ELECTRICAL AND ELECTRONIC EQUIPMENT (WEEE)

EU This appliance is marked according to the European Directive 2012/19/EU on Waste Electrical and Electronic Equipment (WEEE). By ensuring this product is disposed of correctly, you will help prevent potential negative consequences for the environment and human health, which could otherwise be caused by inappropriate handling of this product.

The symbol  marked on the serial plate, or on the documents accompanying the product, indicates that this appliance cannot be treated as household waste. It shall be handed over to the applicable collection point for the recycling of electrical and electronic equipment. Disposal of the appliance shall be carried out in accordance with the local environment regulations for waste disposal and ensure the refrigerant circuit is not damaged.

For more detailed information about treatment, recovery and recycling of this product, please contact your local city office, your household waste disposal service or your Fisher & Paykel retailer/dealer from whom you purchased this product.

FISHERPAYKEL.COM

© Fisher & Paykel Appliances 2024. All rights reserved.

The models shown in this guide may not be available in all markets
and are subject to change at any time.

The product specifications in this guide apply to the specific products and
models described at the date of issue. Under our policy of continuous product
improvement, these specifications may change at any time.

For current details about model and specification availability in your country,
please go to our website or contact your local Fisher & Paykel dealer.

430265C 04.24